

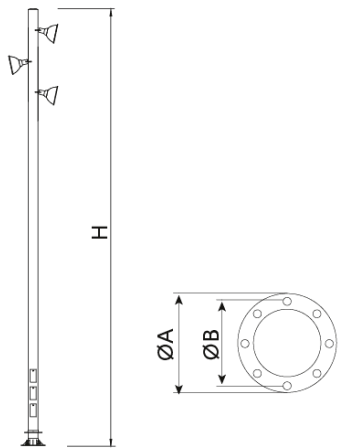



Pole made of S-235-JR hot-dip galvanised steel available in two formats: *Height up to 8 m for TOP mounting of the luminaire with Ø60 mm; *10 and 12 m cylindrical ones are only and exclusively designed for the installation of circular floodlights with outer equipment (can be housed in the 3 service doors available)



Ref.	H	Ø	ØA	ØB	
ICCL100	10000	60	550	430	M22x700
ICCL120	11700	60	550	430	M22x700

[Project sheet](#) | [CAD](#) | [Catalogue](#) | [HD image](#)

The constant improvement and evolution of our products may result in some modifications of the technical specifications and characteristics of the products without prior notice.





The constant improvement and evolution of our products may result in some modifications of the technical specifications and characteristics of the products without prior notice.